

OUTDOOR GAS BURNING FIREPLACES



LUXURY OUTDOOR LIVING

1201 E. WAKEHAM. SANTA ANA. CA 92705
PH. 714-836-5757 FAX 714-836-4433 WWW.PACIFICSTONE.NET

GAS BURNING FIREPLACE COMBINATIONS

**INSTALL ON A 6" SLAB
READY TO APPLY FINISH
EASY ASSEMBLY**

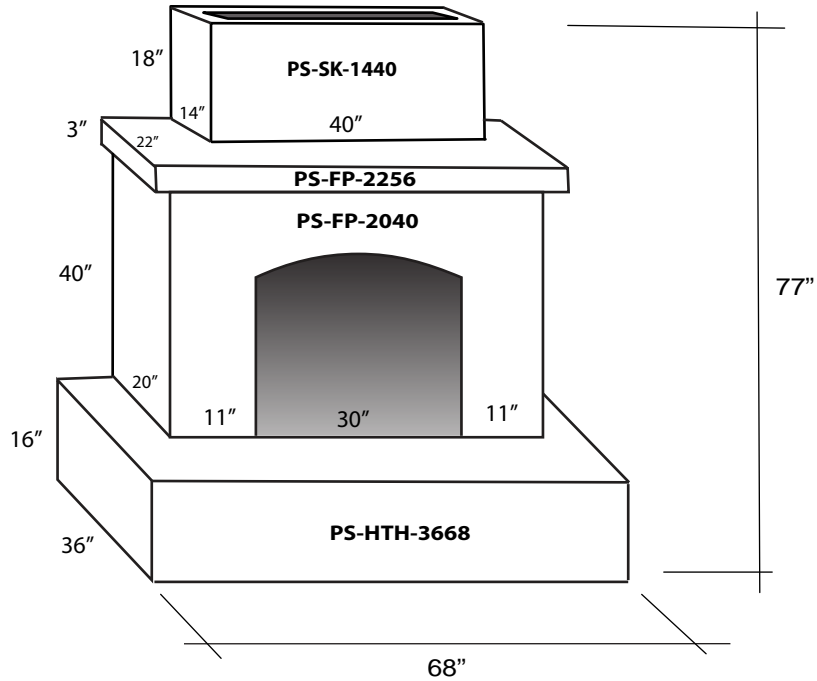

TORREY PINES

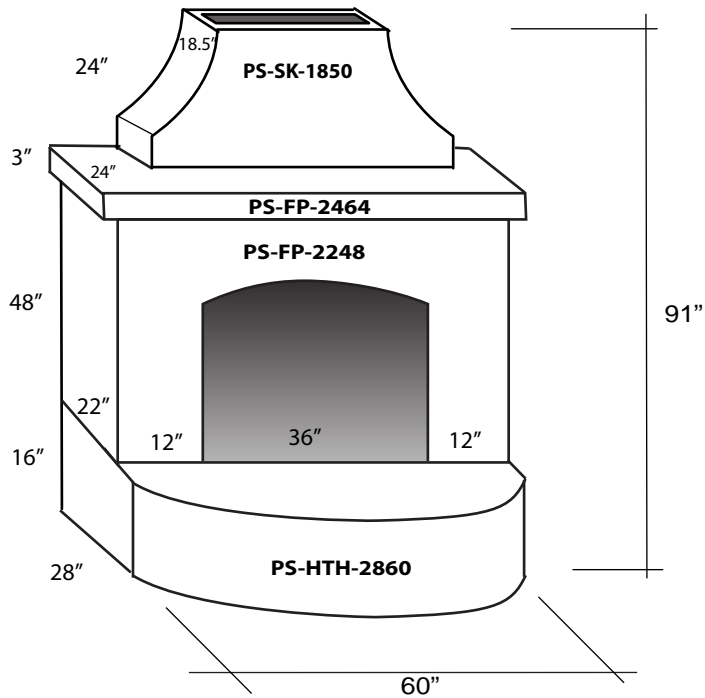

SALINAS

KIT INCLUDES:
MACHINE BOLTS, WASHERS AND NUTS
GAS VALVE

OPTIONS:
REFRACTORY PANELS (SIDES)
FIRE BRICK (QTY 20 FOR BOTTOM)
PRECAST TRIM

GAS BURNING FIREPLACE COMBINATIONS

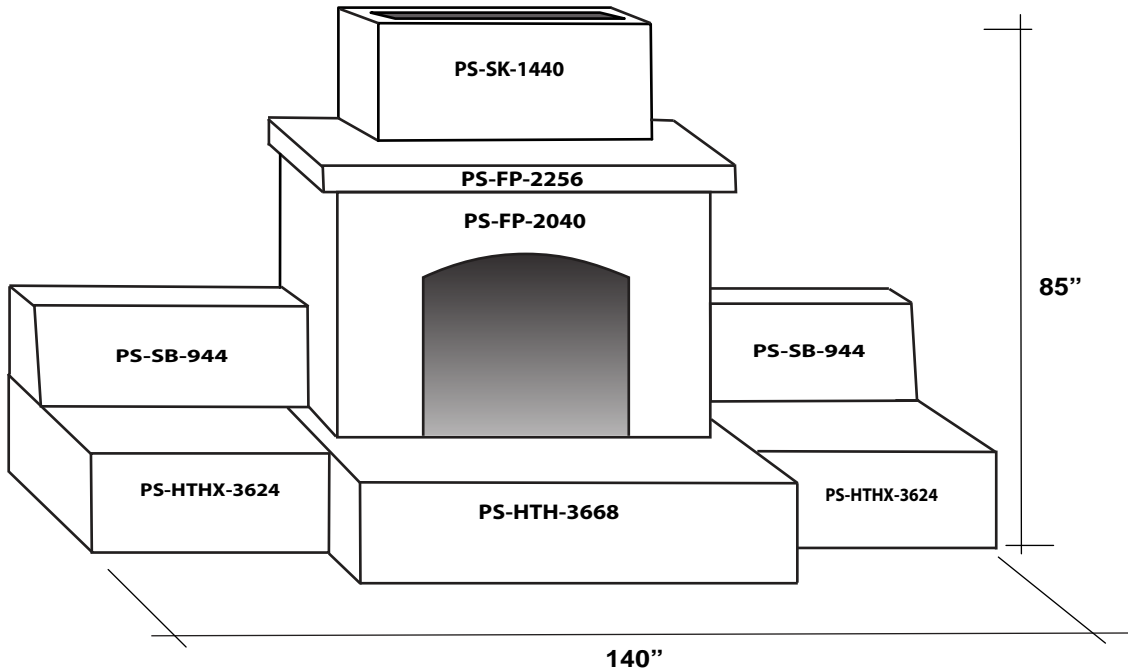

PISMO

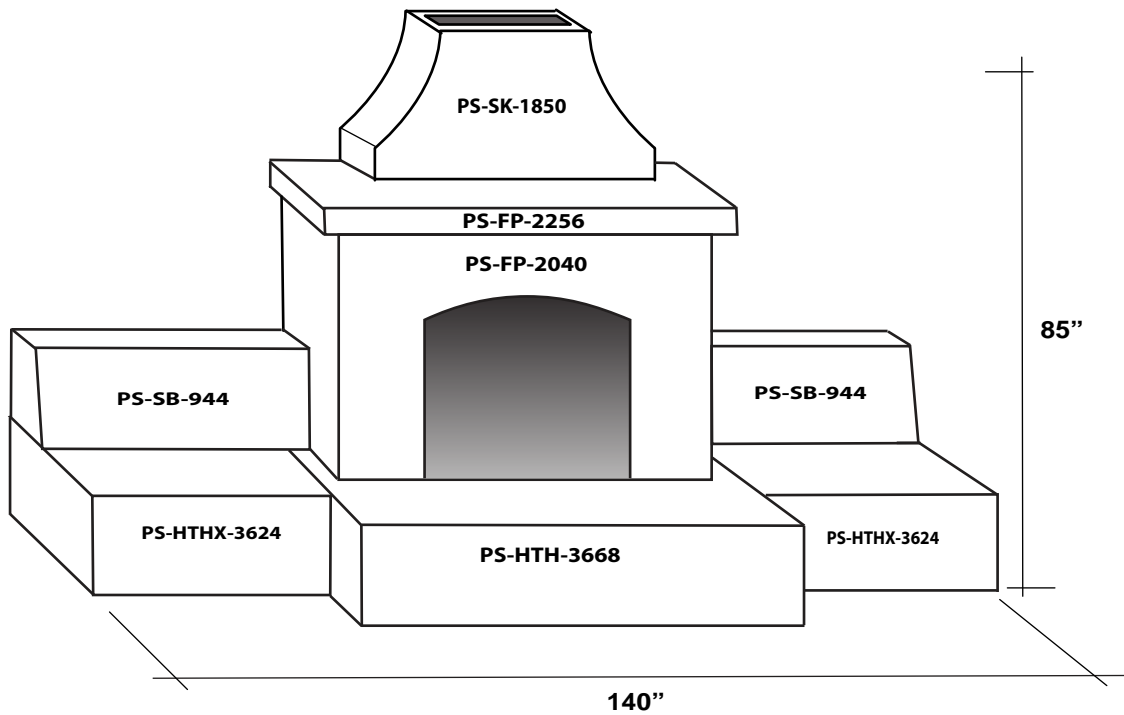

EL MORRO

GAS BURNING FIREPLACE COMBINATIONS

INSTALL ON A 6" SLAB
READY TO APPLY FINISH
EASY ASSEMBLY

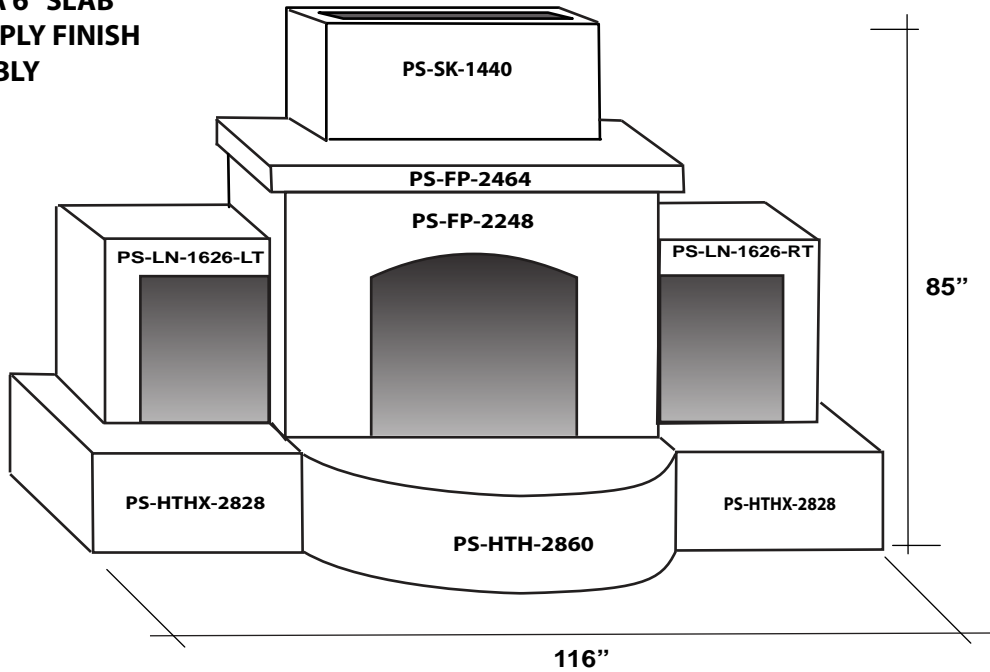

LUNADA

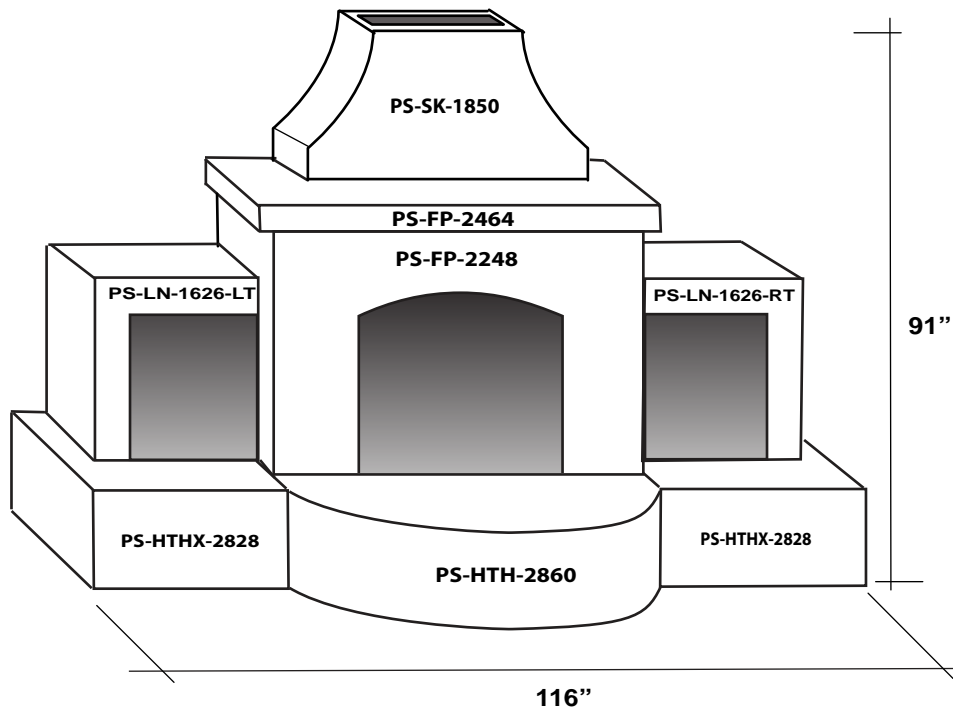

SONOMA

OUTDOOR FIREPLACE ACCESSORIES

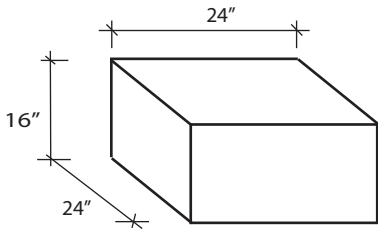

PS-HTHX-2424

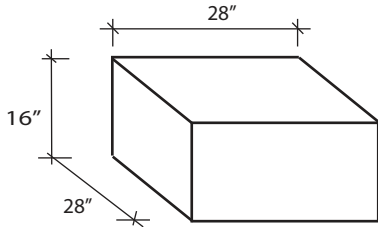

PS-HTHX-2828

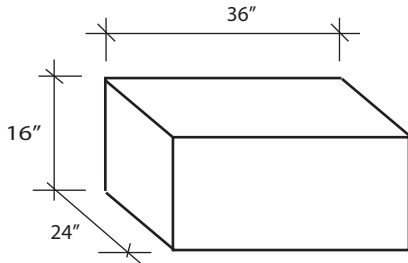

PS-HTHX-3624

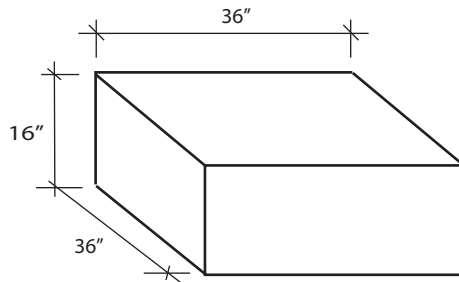

PS-HTHX-3636

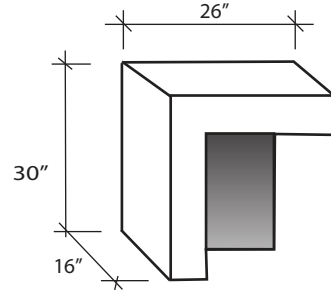

LOG NICHE

**PS-LN-1626-LT
PS-LN-1626-RT**

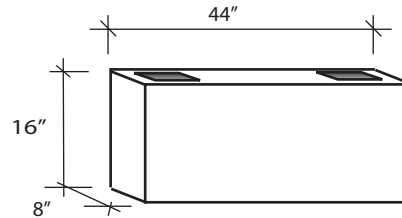

PS-SB-844

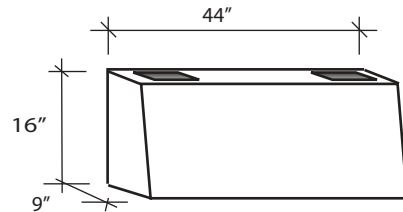

PS-SB-944

KIT INCLUDES:
MACHINE BOLTS, WASHERS AND NUTS
GAS VALVE

OPTIONS:
REFRACTORY PANELS (SIDES)
FIRE BRICK (QTY 20 FOR BOTTOM)
PRECAST TRIM



OUTDOOR GAS BURNING FIREPLACES

EASY ASSEMBLY

INCLUDES: READY TO APPLY FINISH

GAS VALVE

MACHINE BOLTS

PRODUCT LIST

Product	Description	WT. (LBS)
PS-HTH-3668	36" W x 16" H x 68" L HEARTH	390
PS-HTH-2860	35" W x 16" H x 60" L RADUIS HEARTH	370
PS-FP-2040	20" W x 40" H x 52" L FIRE BOX	270
PS-FP-2248	22" W x 48" H x 60" L FIRE BOX	300
PS-FP-2464	24" W x 3" H x 64" L MANTEL	160
PS-FP-2256	22" W x 3" H x 56" L MANTEL	160
PS-SK-1850**	18.5" W x 25" H x 42" L STACK W/ CURVE	160
PS-SK-1440**	14" W x 18" H x 40" L STACK	160
PS-HTHX-3636	36" W x 16" H x 36" L HEARTH EXT	241
PS-HTHX-3624	24" W x 16" H x 36" L HEARTH EXT	187
PS-HTHX-2424	24" W x 16" H x 24" L HEARTH EXT	142
PS-HTHX-2828	28" W x 16" H x 28" L HEARTH EXT	162
PS-SB-844	8" W x 16" H x 44" L SEAT BACK	136
PS-SB-944	9" W x 16" H x 44" L SEAT BACK	146
PS-LN-1626-RT	16" W x 30" H x 26" L LOG NICHE	149
PS-LN-1626-LT	16" W x 30" H x 26" L LOG NICHE	149
PS-SKX-1418	14" W x 18" H x 40" L STACK EXT	190
REF-2238	REFRACTORY PANELS (SET OF 3)	94
PS-FIRE BRICK	FIRE BRICK (SET OF 20)	116

COMBINATIONS

PS-O-SALINA	36"W X 91"H X 60"L	
PS-O-TORREY PINES	36"W X 77"H X 68"L	
PS-O-LUNADA	36"W X 85"H X 116"L	
PS-O-SONOMA	36"W X 91"H X 116"L	
PS-O-EL MORRO	36"W X 88"H X 140"L	
PS-O-PISMO	36"W X 78"H X 140"L	

PRE-CAST PACKAGES

PS-PP-SALINA	MANTLE (180) , HEARTH(910) ,SURROUND(630), TOP(424)	
PS-PP-TORREY PINES	MANTLE (180) , HEARTH(910) ,SURROUND(630), TOP(424)	
PS-PP-LUNADA	MANTLE (180) , HEARTH(910) ,SURROUND(630), TOP(424)	
PS-PP-SONOMA	MANTLE (180) , HEARTH(910) ,SURROUND(630), TOP(424)	
PS-PP-EL MORRO	MANTLE (180) , HEARTH(910) ,SURROUND(630), TOP(424)	
PS-PP-PISMO	MANTLE (180) , HEARTH(910) ,SURROUND(630), TOP(424)	

* CRATING CHARGE MAY APPLY

2/07/18

* CHECK FOR LOCAL BUILDING PERMITS & REQUIREMENTS

** SOME PARTS AVAILABLE PRE-FINISHED

PH. 714-836-5757 FAX 714-836-4433 WWW.PACIFICSTONE.NET