

Coping Installation Guide

- 1.1 Install PSD, INC. Pre-cast plumb, true, and level in accordance with installation instructions and the PSD Technical Data Sheet. All pre-cast should be set by experienced and qualified pre-cast masonry installers.
- 1.2 All substrate receiving PSD, INC. Pre-cast shall be cleaned of any oil, paint, dust, debris, etc. Surface shall be smooth, level, and competent of a firm and permanent adhesion to the setting material. (fig. 2)
- 1.3 Apply waterproofing (super blockade or equalent) 3 coats to bond beam as shown. follow manufactures instructions. (fig. 1)
- 1.4 Apply fortified thinset to waterproofed membrain and coping with notched trowl. Appying fortified thinset in same direction.
- 1.5 Apply mortar (spec mix) and set coping.
- 1.6 Grout coping with approved PSD grout. (see grout detail)
- 1.7 Seal all coping with aqua-mix penetrating sealer. Only apply sealer after coping and grout is free of all moisture, this will help avoid damage by other trades. If a foreign matter does contact the pre cast must be removed immediatly.
- 1.8 It is critical that all PSD, INC. Pre-cast shall be protected from splashing mortar or damage by other trades. If a foreign matter does contact the pre-cast it must be removed immediatly.
- 1.9 PSD, INC. Pre-cast shall be cleaned where necessary by scrubbing with a bristle fiber brush, using soap powder and water. Then rinse thoroughly and generously with water. No acid or prepared cleaners shall be used without the approval of PSD, INC.

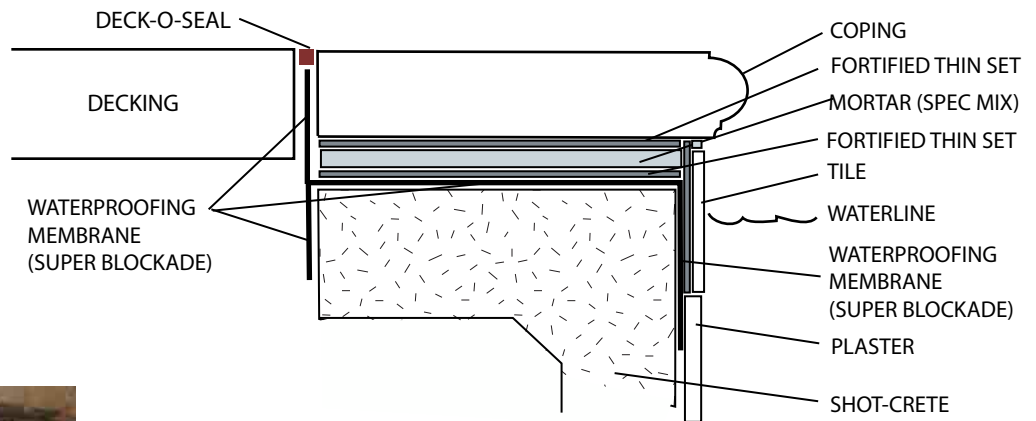

fig. 2



fig.1

IMPORTANT NOTICE

NOTE: WHEN USING SAND SET DECKING

**RECOMMENDED WATERPROOFING
MERLEX "SUPERBLOCKADE" OR EQUIVALENT**

**APPLY WATERPROOFING AT EDGE OF COPING
TO PREVENT MOISTURE FROM ENTERING**



**APPLY WATERPROOFING A MINIMUM OF
2" OVER SHOTCRETE TO PREVENT
MOISTURE FROM ENTERING**



**SEALING W/ AQUAMIX PENETRATING SEALER
IS HIGHLY RECOMMENDED AFTER GROUT IS APPLIED**

NOTE:

- 1.) PRECAST TO BE CONNECTED WITH THIN SET W/ ACRYLIC ADMIX AND SPEC MIX
- 2.) GROUT TO MATCH IN COLOR
- 3.) JOINT "TBD" O.C.